

"8A-HF"

Parts List
(ILLUSTRATED)

MODEL

"8A-HF"

(HORIZONTAL ENGINE)

●
NOTICE

**FILE IN SECTION 2 OF YOUR ENGINE
SERVICE MANUAL.**

**REMOVE AND DESTROY PRESENT
MODEL "8A-HF" PARTS LIST (Form MS-3479)
FROM SECTION 2 OF MANUAL.**

●
*This book is for your service manual only and not for
customer use. Model "8A-H" Operating and Maintenance
Manuals--Form 27572--includes the same parts data for
customer's use and are available at ten cents each.*



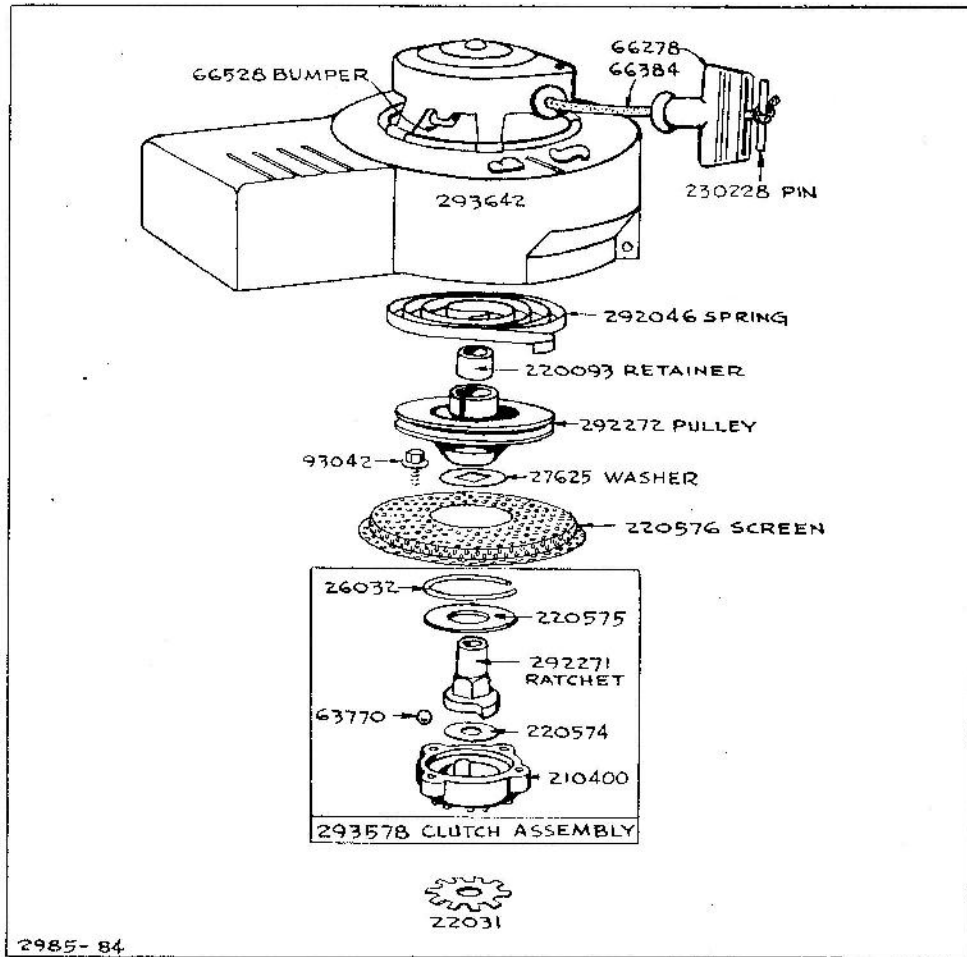

RECOIL STARTER PARTS

Assemblies include all parts shown in frames.

"8A-HF"

PARTS SECTION

NUMERICAL PARTS LIST

MASTER PART No.	NAME	SHIPPING WEIGHT	
		l.bs.	Oz.
21202	Ring—Piston, Compression, Center — Standard	1	
21203	Ring—Piston, Compression, Top—Standard	1	
21216	Venturi—Carburetor	1	
21219	Ring—Piston, Compression, Top—.010" O.S.	1	
21220	Ring—Piston, Compression, Top—.020" O.S.	1	
21221	Ring—Piston, Compression, Top—.030" O.S.	1	
21222	Ring—Piston, Compression, Center—.010" O.S.	1	
21223	Ring—Piston, Compression, Center—.020" O.S.	1	
21224	Ring—Piston, Compression, Center—.030" O.S.	1	
21470	Body—Lower Carburetor	6	
21737	Elbow—Air Cleaner	6	
22031	Lock—Clutch Housing	2	
†22032	Washer—Needle Valve Packing	1	
22036	Valve—Throttle	1	
22050	Valve—Choke	1	
22062	Washer—Choke Lever	1	
22238	Washer—Cylinder Mounting	1	
22243	Washer—Cylinder Mounting	1	
22279	Brace—Air Cleaner Elbow	1	
*22353	Washer—Valve Cover	1	
22725	Washer	1	
†23114	Pin—Float Hinge	1	
23184	Retainer—Valve Spring	1	
	Note: No. 202259 Rotocap—Exhaust Valve. Used on type No. 209723.	2	
23187	Pin—Valve Spring Retainer	1	
	Note: No. 230126 Pin—Exhaust Valve Rotocap Retainer. No. 230127 Retainer—Exhaust Valve Rotocap. Used on type No. 209723.	1	
†23222	Nozzle—Carburetor	1	
†23227	Nut—Needle Valve Packing	1	
23230	Bushing—Throttle Shaft	1	
23270	Screw—Choke Lever	1	
23292	Bolt—Air Cleaner—6 $\frac{1}{4}$ " Long	2	
23444	Stud—Valve Cover	1	
23663	Valve—Exhaust	2	
	Note: No. 20515 Valve—Exhaust Used on type No. 209723.	2	
23688	Bushing—Control Lever	1	
26021	Spring—Intake Valve	1	
26026	Lock—Piston Pin	1	
26032	Spring—Clutch Retainer	1	
†26157	Spring—Throttle Adjustment	1	
26229	Spring—Choke Lever	1	
26330	Spring—Breather Retainer	1	
26478	Spring—Exhaust Valve	1	
	Note: No. 26826 Spring—Exhaust Valve Used on type No. 209723.	1	
26760	Spring—Governor	1	
26880	Link—Governor	1	
26910	Crankshaft	3	
	Note: No. 26904 Crankshaft Used on type No. 209725.	3	

† Included in Carburetor Overhaul Kit — Part No. 291691.

* Included in Gasket Set — Part No. 293324.

PARTS SECTION

MASTER PART No.	NAME	SHIPPING WEIGHT	
		Lbs.	Oz.
27323	Gasket—Breather Body		1
*27355	Gasket—Intake Elbow Mounting		1
27402	Gasket—Air Cleaner		1
*27423	Gasket—Air Cleaner Mounting		1
*27463	Gasket—Cylinder Head		1
27567	Gasket—Oil Sump Cover		1
*27596	Gasket—Engine Base		1
27625	Washer—Ratchet Sealing		1
29667	Breaker Assembly—Ignition		2
	Note: No. 292234 Breaker Assembly		2
	Used on type No. 209723.		
29693	Plug—Spark—With Gasket		3
	Note: No. 292519 Plug—Spark—With Gasket		4
	Used on type No. 209723.		
29806	Gasket—Spark Plug		1
29835	Flywheel—Magneto	6	
29861	Condenser		2
	Note: No. 290593 Condenser		2
	Used on type No. 209723.		
38852	Washer—Armature and Breaker Mounting		1
61505	Ring—Piston, Oil—Standard		1
61703	Gear—Cam	1	8
61747	Ring—Piston, Oil—.010" O.S.		1
61748	Ring—Piston, Oil—.020" O.S.		1
61749	Ring—Piston, Oil—.030" O.S.		1
61760	Key—Flywheel		1
61967	Stop—Throttle Lever		1
62577	Washer—Flywheel		1
62835	Cover—Dust		4
63217	Nut—Needle Valve Packing		1
63770	Ball—Clutch		1
63785	Shaft—Cam		3
63788	Tappet—Valve		1
63797	Wrench—Socket Screw		3
65534	Gasket—Filler Cap		1
65704	Plunger—Breaker Point		1
65968	Disc—Breather		1
66111	Connector—Fuel Pipe		1
*66114	Washer—Cylinder Mounting		1
66278	Grip—Starter Rope		2
66381	Rope—Starter		1
66418	Slinger—Oil		2
66428	Gear—Idler		2
66432	Washer—Control Lever Mounting		1
66438	Insulator—Stop Switch		1
	Note: No. 66498 Insulator—Stop Switch		1
	Used on type No. 209723.		
66528	Bumper—Starter Pulley		1
*67307	Gasket—Magneto Plate—.015" thick		1
*67527	Gasket—Valve Cover		1
*67597	Gasket—Magneto Plate—.005" thick		1
*67607	Gasket—Magneto Plate—.009" thick		1
68122	Plug—Cam Shaft		1
†68857	Gasket—Carburetor Body		1
68877	Gasket—Fuel Inlet Valve Seat		1

* Included in Gasket Set—Part No. 293324.

† Included in Carburetor Overhaul Kit—Part No. 291691.

"8A-HF"

PARTS SECTION

MASTER PART No.	NAME	SHIPPING WEIGHT	
		Lbs.	Oz.
†68887	Packing—Needle Valve	1	
68897	Gasket—Carburetor Venturi	1	
*†68987	Gasket—Carburetor Mounting	1	
69221	Cap—Fuel Tank	2	
69932	Rope—Starter	6	
89307	Valve—Oil Return	1	
89660	Seal—Oil	1	
89677	Bushing—Magneto	2	
	Includes: No. 89660 Seal—Oil		
89906	Muffler	8	
90029	Screw—Machine, Rd. Hd.—4-36x $\frac{1}{4}$	1	
90202	Screw—Machine, Fill. Hd.—10-32x $\frac{1}{2}$ "	1	
90369	Washer—Lock—No. 4x $\frac{1}{2}$ x $\frac{1}{2}$ "	1	
90576	Nut—Hex.—8-32	1	
90832	Washer—Lock— $\frac{1}{4}$ x $\frac{3}{8}$ x $\frac{1}{2}$ "	1	
	Note: No. 92778 Washer—Lock—Shakeproof	1	
	Used to mount the blower housing on type No. 209723.		
90847	Nut—Hexagon— $\frac{1}{4}$ -28	1	
91397	Nut—Hex.— $\frac{1}{8}$ -18	1	
91419	Screw—Cap, Hex. Hd.— $\frac{1}{4}$ -20x $\frac{3}{8}$ "	1	
91439	Screw—Cap, Hex. Hd.— $\frac{1}{4}$ -20x $\frac{3}{8}$ "	1	
91488	Plug—Pipe, $\frac{1}{8}$ " Standard, Sq. Hd.	1	
91708	Nut—Flywheel	1	
91811	Locknut—Exhaust Elbow	2	
91920	Screw—Machine, Fill. Hd.—8-32x $\frac{5}{8}$ "	1	
91943	Elbow—Exhaust	3	
92067	Nut—Wing	1	
92089	Screw—Machine, Fill. Hd.— $\frac{1}{4}$ -20x $\frac{3}{4}$ "	1	
92208	Screw—Connecting Rod	1	
92227	Washer—Lock—Shakeproof No. 1320	1	
92290	Washer—Lock—No. 10x $\frac{1}{2}$ x $\frac{3}{4}$ "	1	
92701	Screw—Magneto Mounting Sem	1	
92702	Screw—Condenser Mounting Sem	1	
92703	Screw—Dust Cover Mounting Sem	1	
92708	Screw—Armature Mounting Sem	1	
92709	Screw—Breaker Mounting Sem	1	
92734	Screw—Cap, Hex. Hd.— $\frac{1}{4}$ -20x $\frac{1}{2}$ "	1	
92739	Screw—Self-Tapping, Hex. Hd.—10-32x $\frac{1}{2}$ "	1	
92791	Washer—Lock—Shakeproof	1	
92863	Screw—Self-Tapping, Hex. Hd.— $\frac{1}{4}$ -28x $\frac{5}{8}$ "	1	
92909	Screw—Cylinder Head	1	
92952	Screw—Machine, Rd. Hd.—8-32x $1\frac{1}{4}$ "	1	
92955	Screw—Throttle Housing Mounting Sem	1	
92993	Screw—Base Mounting	1	
92995	Screw—Base Mounting	1	
92998	Washer—Lock (Sump Mounting)	1	
92999	Screw—Cap, Hex. Hd.— $\frac{1}{4}$ -28x $1\frac{1}{8}$ "	1	
93000	Screw—Cap, Socket Hd.— $\frac{1}{4}$ -28x $\frac{1}{4}$ "	1	
93002	Screw—Cap, Hex. Hd.— $\frac{1}{4}$ -20x $1\frac{1}{8}$ "	1	
93004	Washer—Lock—Shakeproof No. 1418-00	1	
93042	Screw—Rotating Screen Mounting Sem	1	
93043	Pin—Throttle Stop	1	
99634	Body—Upper Carburetor	4	
99700	Shaft and Lever—Choke	2	

† Included in Carburetor Overhaul Kit — Part No. 291691.

* Included in Gasket Set — Part No. 293324.

PARTS SECTION

MASTER PART No.	NAME	SHIPPING WEIGHT	
		Lbs.	Oz.
210028	Body--Breather		1
210086	Head--Cylinder	1	4
210087	Elbow--Intake		8
210100	Housing--Starter Clutch	1	
220020	Lock--Connecting Rod Screw		1
220093	Retainer--Spring		1
220167	Housing--Blower		14
	Note: No. 222838 Housing--Blower (with stop switch)		1
	Used on type No. 209723.		
220171	Cover--Cylinder Head		4
220172	Shield--Cylinder		3
220197	Switch--Stop		1
220221	Shield--Carburetor		2
220228	Cover--Valve		6
220229	Cover--Breather		1
220247	Plate--Oil Baffle		2
220311	Cover--Oil Sump		10
220418	Lever--Governor Control		2
220421	Support--Governor Lever		2
220450	Bracket--Fuel Tank (Right Hand)		4
220451	Bracket--Fuel Tank (Left Hand)		4
220467	Bracket--Remote Control		2
220574	Washer--Starter Clutch Thrust		1
220575	Washer--Clutch Retainer		1
220576	Screen--Recoil Starter		2
†230005	Valve--Needle		1
230061	Valve--Intake		2
	Note: No. 230101 Valve--Intake		2
	Used on type No. 209723.		
230187	Valve--Fuel Shut-off (Use Part No. 293934)		1
230213	Bushing--Oil Slinger		1
230221	Plug--Oil Drain		3
230226	Pin--Idler Gear		1
230228	Pin--Starter Grip		1
200413	Cap--Oil Filler		4
290820	Ring Set--Standard Piston		3
290821	Ring Set--.010" O.S. Piston		3
290822	Ring Set--.020" O.S. Piston		3
290823	Ring Set--.030" O.S. Piston		3
291617	Armature--Magneto	1	2
	Note: No. 292184 Armature Assembly	1	2
	Used on type No. 209723.		
291691	Carburetor Overhaul Kit		6
291801	Carburetor Assembly	1	
291803	Shaft and Lever Assembly--Throttle		1
291815	Rod Assembly--Connecting		10
291832	Seal--Oil		1
291838	Cleaner Assembly--Air	1	
291921	Piston Assembly--Standard		8
291922	Piston Assembly--.010" O.S.		8
291923	Piston Assembly--.020" O.S.		8
291924	Piston Assembly--.030" O.S.		8
291925	Pin Assembly--Piston--Standard		2
291926	Pin Assembly--Piston--.005" O.S.		2
292013	Body Assembly--Upper Carburetor		4
292037	Cover and Filter--Air Cleaner		8

† Included in Carburetor Overhaul Kit -- Part No. 291691.

PARTS SECTION

MASTER PART No.	NAME	SHIPPING WEIGHT	
		Lbs.	Oz.
292038	Bowl—Air Cleaner		6
292046	Spring—Starter		5
292149	Cable—Ignition		2
	<i>Note: No. 293141 Cable—Ignition</i>		3
	Used on type No. 209723.		
292271	Ratchet—Recoil Starter		3
292272	Pulley—Recoil Starter	1	
292602	Bushing—Cylinder		3
292602	Bushing—Cylinder		1
†292681	Valve Assembly—Carburetor Idle		2
292692	Breather Assembly		2
292797	Outlet—Fuel Tank (includes strainer)		2
292952	Tank Assembly—Fuel	2	
292960	Pipe—Fuel—16½" long		4
293032	Magneto Assembly	4	
	<i>Note: No. 293331 Magneto Assembly</i>	4	
	Used on type No. 209723.		
	Includes: No. 202042 Wire—Ground		1
293033	Plate—Magneto	2	
293034	Blade—Governor		3
293138	Stator Pulley with Screen		12
293324	Gasket Set		4
293333	Sump—Oil	2	4
293376	Cylinder	14	
	<i>Note: No. 293377 Cylinder</i>	14	
	Used on type No. 209723.		
293477	Float—Carburetor		3
	<i>Note: No. 99622 Float—Carburetor</i>		3
	Used on engines before Serial No. 429607.		
†293478	Valve and Seat—Fuel Inlet		1
	<i>Note: No. 90636 Valve and Seat—Fuel Inlet</i>		1
	Used on engines before Serial No. 429607.		
293578	Clutch Assembly—Starter	1	8
293642	Housing—Blower	2	
293934	Valve Assembly—Fuel Shut-off		1

* Included in Carburetor Overhaul Kit — Part No. 291691.